

| TYPE | OUTPUT | | POLE | TIME RATING | VOLTAGE V | Hz | SYN. SPEED R.P.M |
|--------|--------|-----|------|-------------|-----------|----|------------------|
| | HP | KW | | | | | |
| AEHH8B | 350 | 261 | 4 | CONT. | 460 | 60 | 1800 |

TOTALLY ENCLOSED FAN-COOLED TYPE. SQUIRREL-CAGE ROTOR

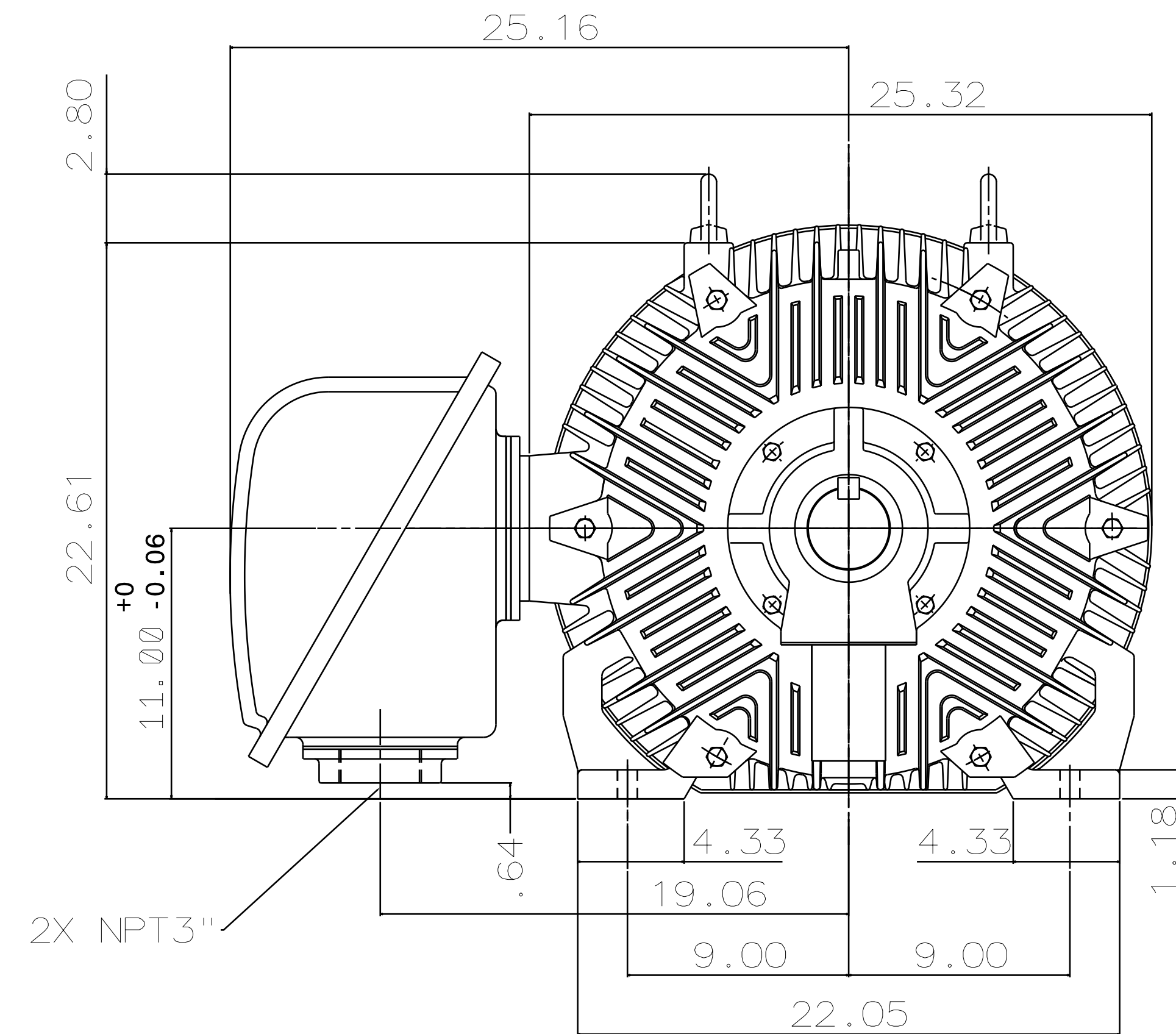
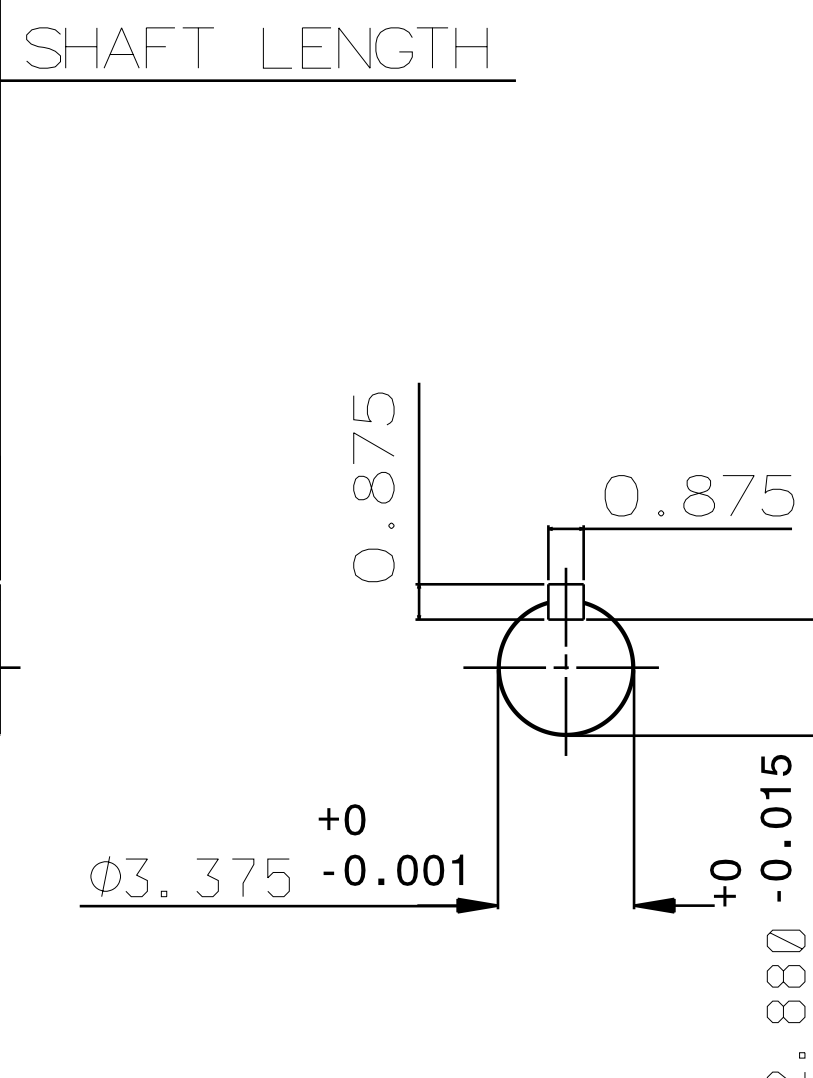
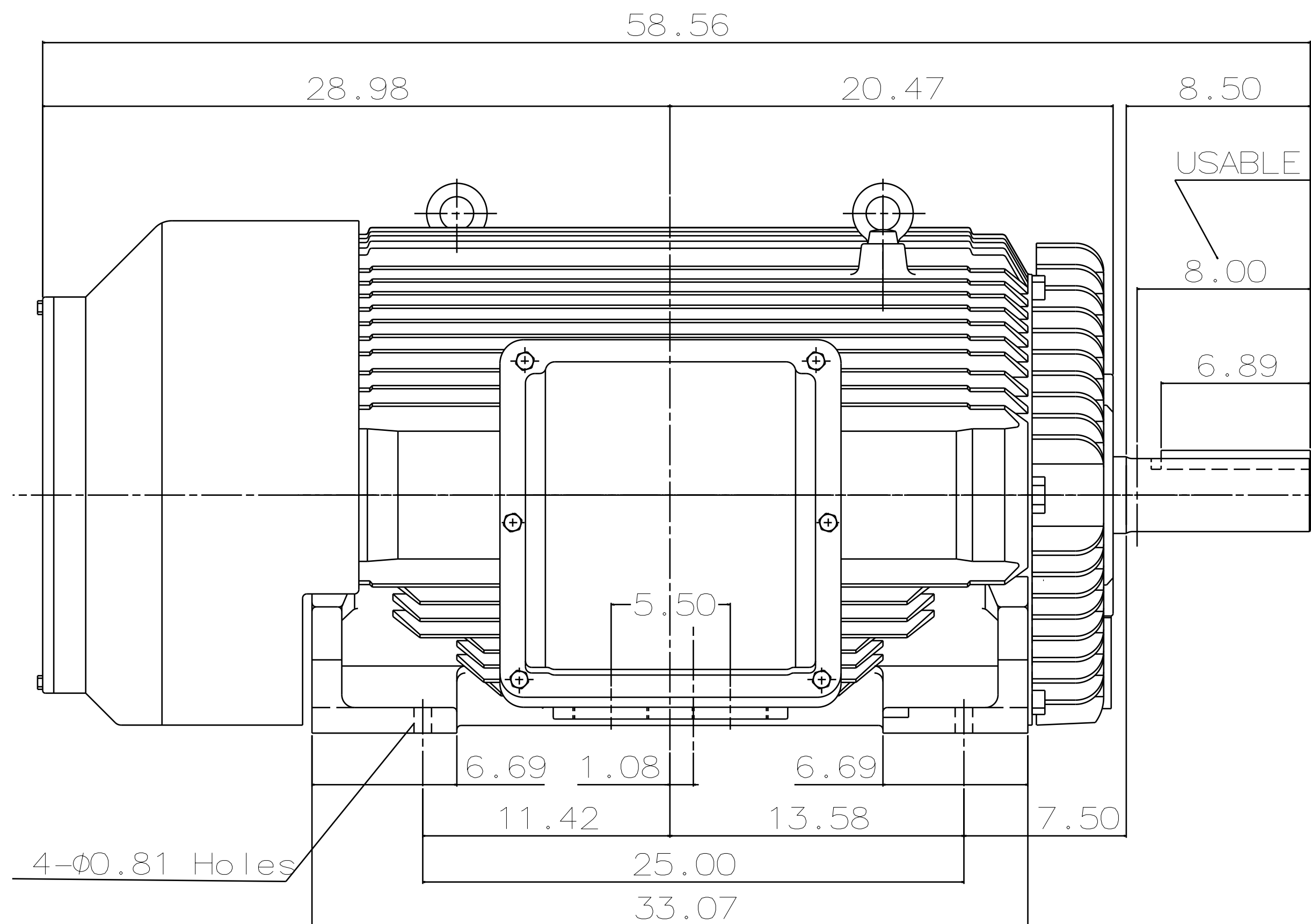

NOTE :

1. DIMENSIONS IN INCH.
2. FRAME NO. 449T
3. F CLASS INSULATION, S.F.1.15
4. FOR DIRECT FLEXIBLE COUPLING.
5. BEARING SIZE: DRIVE END: 6320
NON-DRIVE END: 6316
6. MOTOR APPROX. WEIGHT: 3350 LBS
7. ENCLOSURE: IP55
8. INPRO SEAL ON BOTH ENDS.
9. NON-SPARKING FAN.
10. NOISE BELOW 83 DBA AT 1 METER AT NO LOAD.
11. VIBRATION VERTICAL/HORIZONTAL BELOW 0.08 IN/SEC
AXIAL BELOW 0.06 IN/SEC.

TW-56BC

| | |
|-------------|----------|
| DATE | 12-12-17 |
| CATALOG NO. | HB3504 |

OUTLINE DIMENSIONS
3-PHASE INDUCTION MOTOR

| | | |
|-------|---------|-------------|
| DWN. | W.CHENG | MAY.10.2004 |
| CHKD. | H.HUANG | MAY.10.2004 |
| APPD. | C.WANG | MAY.10.2004 |

TECO Westinghouse

| | |
|-----------|---------|
| DWG NO. | REV: 02 |
| 3A040W799 | |