

CATALOG #	TYPE	FRAME	OUTPUT		POLE	SYN. SPEED R.P.M.	VOLTAGE V.	Hz.	TIME RATING	INSULATION CLASS	SERVICE FACTOR	BEARINGS		WEIGHT LBS
			HP	KW								DE	NDE	
KPF2006R	AFHP	5009C	200	149.1	6	1200	2300/4000	60	CONT.	F	1.15	NU324C3	6320C3	4030

TOTALLY ENCLOSED FAN-COOLED TYPE. SQUIRREL CAGE MOTOR

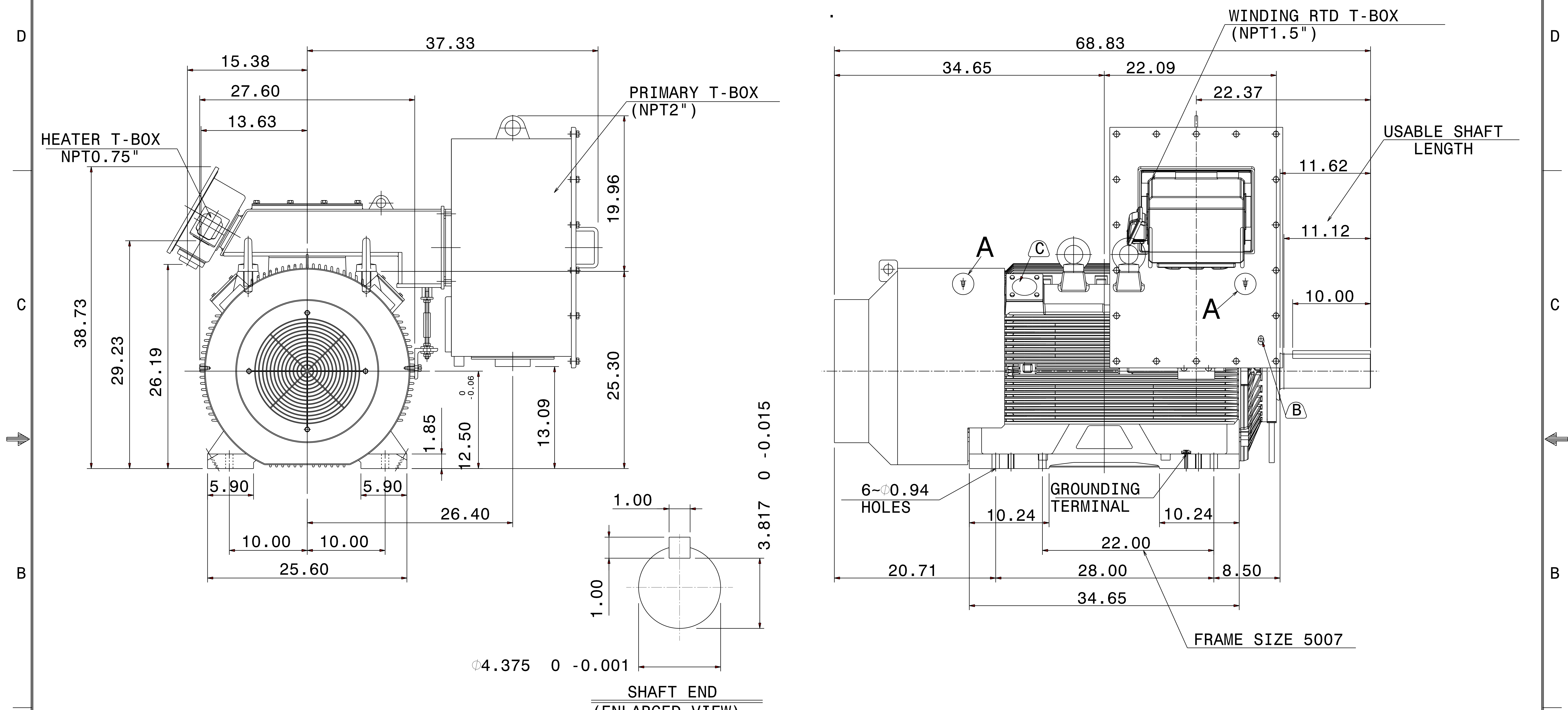

- NOTE:
1. DIMENSIONS IN inch
 2. ENCLOSURE: IP55
 3. F CLASS INSULATION
 4. FOR DIRECT FLEXIBLE COUPLING
 5. WITH SAPCE HEATER & WINDING RTD

- (B) FOR BEARING RTD, END BRACKETS SHALL BE PRE-DRILLED AND PLUGGED.
 (C) FOR AUXILIARY, FRAME SHALL BE PRE-DRILLED AND COVERD WITH STEEL PLATE.
 6. 4~M20 VERTICAL JACKING HOLES, 90° APART IN MOTOR BASE

1/4" -28UNF TAP,
 \XDEPTH 12mm
DETAIL A
 PROVISION FOR VIBRATION DETECTORS

DATE			OUTLINE DIMENSIONS	
KPF2006R			3-PHASE INDUCTION MOTOR	
DWN.	L. JHENG	APR 29 2019	DWG NO.	REV: 01
CHKD.	H. WANG	APR 30 2019	5A040C215	
APPD.	C. WANG	APR 30 2019	1/1	

