

CATALOG #	TYPE	FRAME	OUTPUT		POLE	SYN. SPEED R.P.M.	VOLTAGE V.	Hz.	TIME RATING	INSULATION CLASS	SERVICE FACTOR	BEARINGS		WEIGHT LBS
			HP	KW								DE	NDE	
KPF2506R	AFHP	5009C	250	186.5	6	1200	2300/4000	60	CONT.	F	1.15	NU324C3	6320C3	3560

TOTALLY ENCLOSED FAN-COOLED TYPE, SQUIRREL-CAGE ROTOR

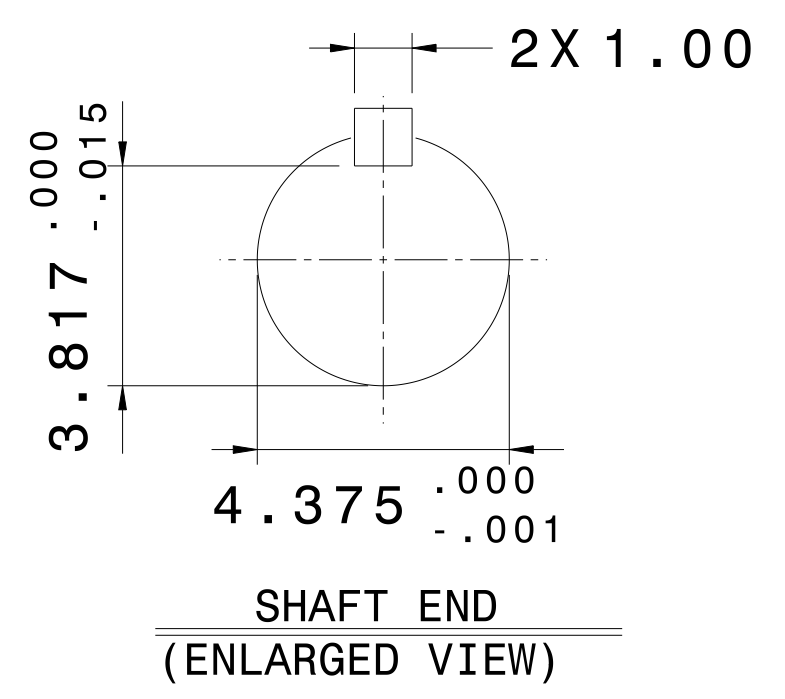
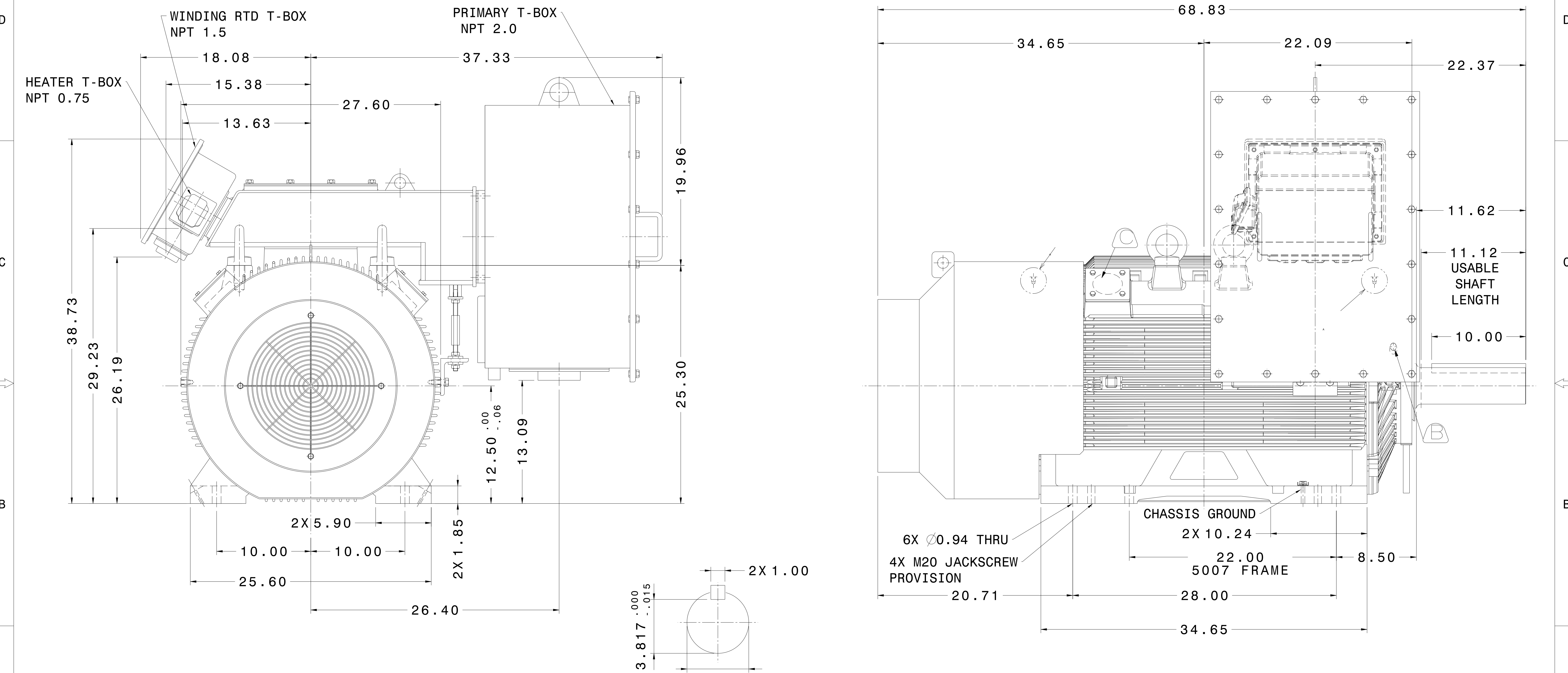

1/4" -28UNF TAP, DEPTH 0.50

DETAIL A
PROVISION FOR VIBRATION DETECTORS

- NOTE:
1. DIMENSIONS IN INCH.
 2. ENCLOSURE: IP55.
 3. FOR DIRECT FLEXABLE COUPLING.
 4. WITH SPACE HEATERS AND WINDING RTD.
 5. 4X M20 VERTICAL JACKING SCREW PROVISION.
- Ⓟ FOR BEARING RTD, END BRACKET SHALL BE PRE-DRILLED AND PLUGGED.
- Ⓢ FOR AUXILIARY, FRAME SHALL BE PRE-DRILLED AND COVERED WITH STEEL PLATE.

REV. DATA	TECO Westinghouse		REV NO	01
	3-PHASE INDUCTION MOTOR		DWG NO.	5A040C208
		OUTLINE DIMENSIONS		KPF2506R
REF:	DWN. P. BRYAN	061625	APPD. C. COOK	061625
	TECO-WESTINGHOUSE MOTOR COMPANY		ROUND ROCK, TEXAS USA	